

REV. NO.	REVISION NOTE	REVISER	DATE
V0	NEW DRAWING		2023/02/24

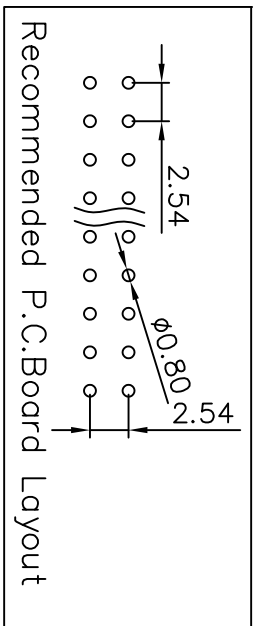
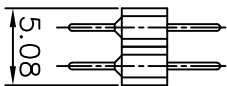
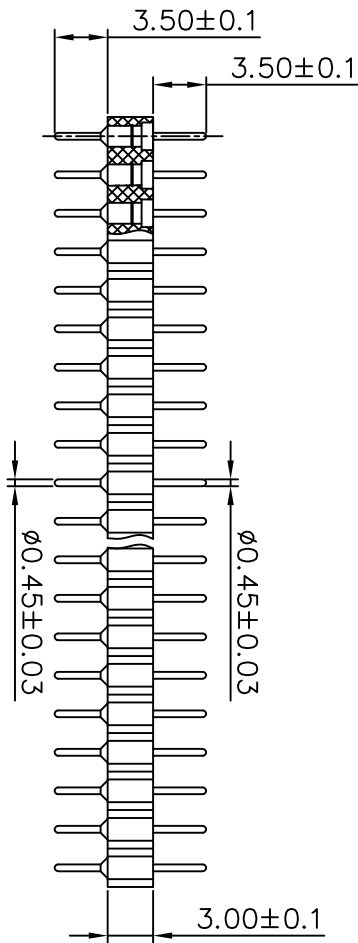
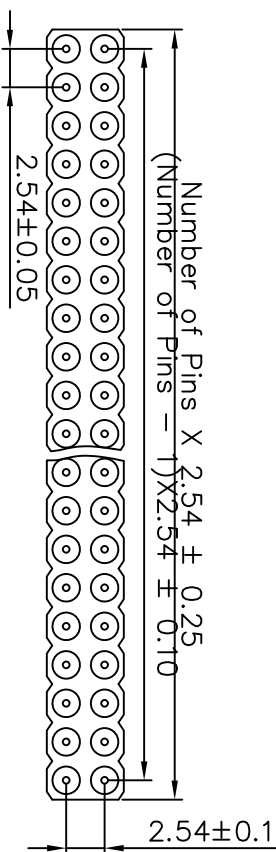

Technical Specs:

- Insulator: Black glass filled polyester PPS-GF30-FR
- Flammability: UL 94V-0
- Sleeve: Brass CuZn36Pb3 (C36000)
- Mechanical life: min 500 cycles
- Rated current: 3 A
- Contact resistance: max 20 Milliohms
- Dielectric strength: min 1000 V RMS
- Coplanarity SMDterminations: max 0.1 mm (measured on 25 mm long connectors)

		深圳市新世联电子有限公司 TEL: +86 (755) 29912370 FAX: 29912372	
Http://www.ciscomm.com		Title	
Tolerance Unless Otherwise Specified		Units	
.X ~ ±0.30	mm	Scale	REV NO.
.XX ~ ±0.25	mm	2:1	V0
.XXX ~ ±0.20	mm	Reviewed By	Date
Angle ~ ± 3°		Date	Approval By